

THE METROPOLITAN

Event Spaces & Capacities

66th FLOOR

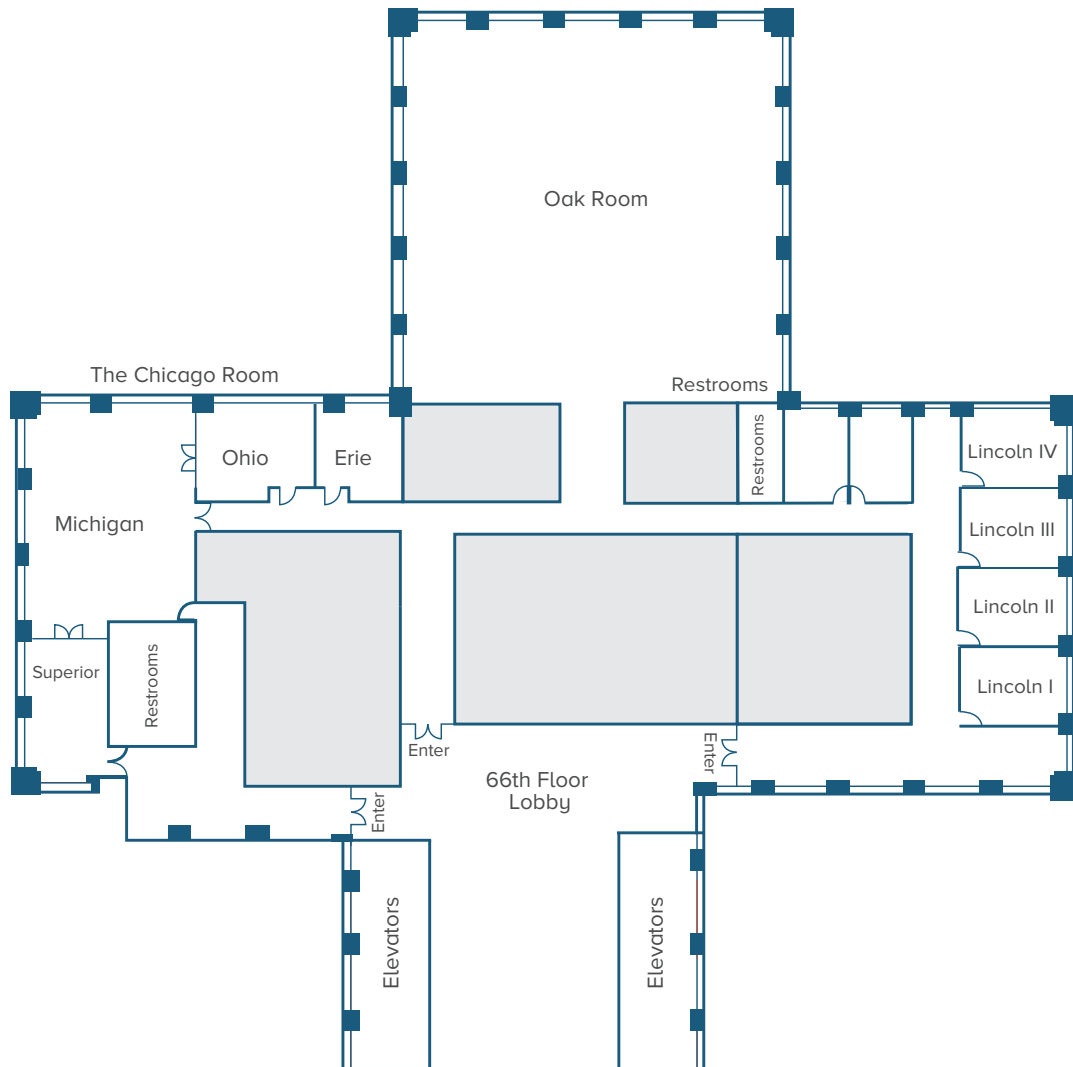

| ROOM | CONFERENCE CAPACITY | RECEPTION CAPACITY | ROUNDS |
|--|---------------------|--------------------|--------|
| Superior | 24 | 35 | 30 |
| Michigan | 30 | 100 | 90 |
| Ohio | 16 | 15 | 20 |
| Erie | 12 | 15 | 10 |
| Ohio/Erie | 30 | 40 | 40 |
| Chicago <i>(Superior, Michigan, Ohio & Erie Rooms combined)</i> | – | 240 | 160 |
| Oak | – | 400 | 250 |
| Lincoln I | 12 | 15 | 12 |
| Lincoln II | 12 | 15 | 12 |
| Lincoln III | 12 | 15 | 12 |
| Lincoln IV | 12 | 15 | 12 |
| Lincoln I-IV | 80 | 100 | 90 |



THE
METROPOLITAN

A Member of the ClubCorp Family

CONTACT A PRIVATE EVENT
DIRECTOR TODAY!

312.876.3200

contactus@metclubchicago.com