

HOLE	RATING/SLOPE	1	2	3	4	5	6	7	8	9	OUT	I N I T I A L S	10	11	12	13	14	15	16	17	18	IN	TOT	HCP	NET	
GOLD	70.7/138	392	(482)	(165)	370	354	(131)	(334)	503	(531)	3262			374	227	(355)	(489)	(326)	(487)	181	(358)	(370)	3167	6429		
BLUE	68.8/125	(352)	450	135	(317)	(331)	124	300	(420)	491	2920			(345)	(176)	330	462	309	454	(162)	332	327	2897	5817		
WHITE	67.3/120	347	439	121	311	317	113	288	385	461	2782			339	162	323	430	306	445	141	327	302	2775	5557		
HANDICAP		3	7	13	11	9	15	17	1	5				6	10	2	14	16	18	12	4	8				
+/-																										
<b>PAR</b>		<b>4</b>	<b>5</b>	<b>3</b>	<b>4</b>	<b>4</b>	<b>3</b>	<b>4</b>	<b>4</b>	<b>5</b>	<b>36</b>		<b>4</b>	<b>3</b>	<b>4</b>	<b>5</b>	<b>4</b>	<b>5</b>	<b>3</b>	<b>4</b>	<b>4</b>	<b>36</b>	<b>72</b>			
+/-																										
FORWARD	68.6/118	321	415	103	286	(238)	107	247	(335)	(425)	2477		(226)	148	296	310	278	(387)	125	(289)	(249)	2308	4785			
WHITE	72.7/137	(347)	(439)	(121)	(311)	317	(113)	(288)	385	461	2782		339	(162)	(323)	(430)	(306)	445	(141)	327	302	2775	5557			
HANDICAP		5	3	17	13	11	9	15	1	7			18	16	2	4	8	10	14	6	12					

○ MEN'S MEMBER TEES: 70.0/134 • 3063 YDS (OUT) • 3068 (IN) • 6131 (TOT)
 
○ LADIES' MEMBER TEES: 70.6/126 • 2617 (OUT) • 2513 (IN) • 5130 (TOT)

SCORER: \_\_\_\_\_ ATTEST: \_\_\_\_\_ DATE: \_\_\_\_\_

**USGA Rules Govern All Play**

All Yardages Measure To Center Of Green  
Please Repair Ball Marks And Fill Divots

**Local Rules:**

- Drop Area over water on #10
- Drop Area next to green on #16
- Interior out of bounds on #9 only
- Free relief from electric fans around the green; stance and swing, and line of sight

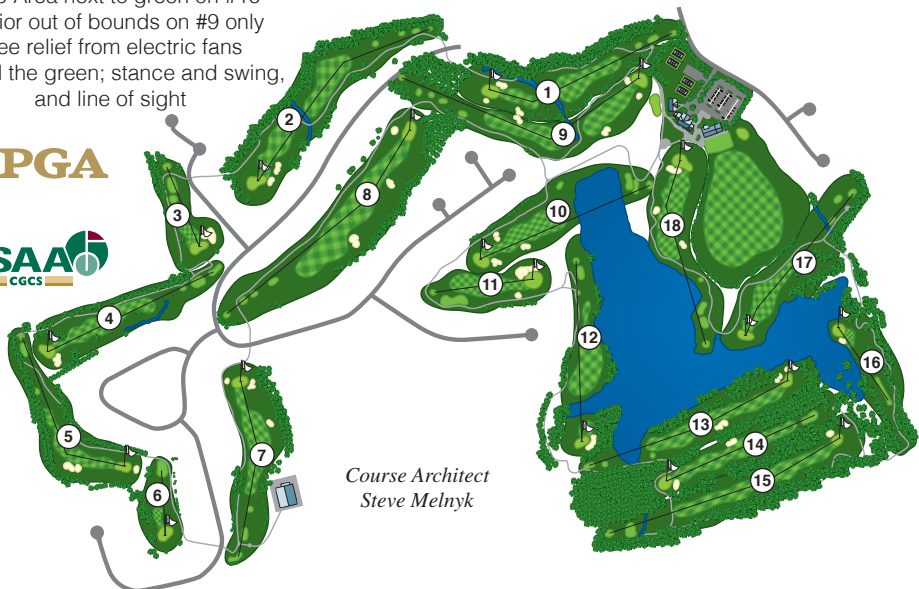

Course Architect  
Steve Melnyk

3254 Clubside View Court, Snellville, GA 30039 • Golf Shop (770) 978-7755  
For membership information, please call (770) 978-7755 • Visit our website at: [www.countryclubofgwinnett.com](http://www.countryclubofgwinnett.com)

